

Rounthwaite **R&W** Woodhead

53 MARKET PLACE, MALTON, NORTH YORKSHIRE, YO17 7LX Tel: (01653) 600747

SOUTH LODGE, HOVINGHAM HALL HOVINGHAM, YORK, YO62 4LX



£1,750 PER MONTH

Also at: 26 Market Place, Kirkbymoorside Tel: (01751) 430034 & Market Place, Pickering Tel: (01751) 472800

Email: malton@rounthwaite-woodhead.co.uk www.rounthwaite-woodhead.com

Description

This beautifully renovated three-bedroom home is set within the prestigious grounds of Hovingham Hall, offering privacy, space, and timeless character. Accessed via a private entrance, the property features a stylish kitchen and lounge on the ground floor, enhanced by exposed beams throughout.

The principal bedroom benefits from a luxurious en-suite, while two further bedrooms are served by a high-quality family bathroom. To the rear, a stunning private patio set within the original walls provides a secluded outdoor retreat, perfect for relaxed outdoor living.

Elegant, private, and impeccably finished, this is a truly exceptional residence in a distinguished setting.

Arranged over three floors the accommodation briefly comprises;

Ground floor: kitchen, dining and lounge.

First floor: two double bedrooms and family bathroom

Second floor: principle bedroom with ensuite and walk in closet

General Information



Accommodation

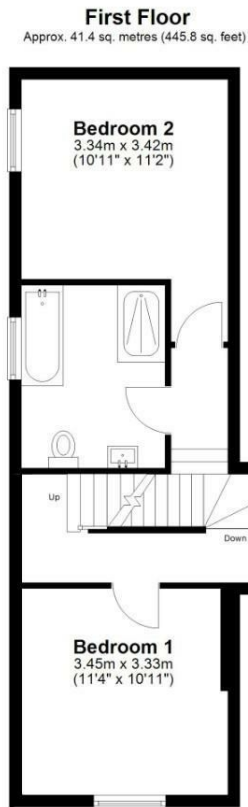

Total area: approx. 119.2 sq. metres (1282.6 sq. feet)
South Lodge, Hovingham

Energy Efficiency Rating		Current	Potential
Very energy efficient - lower running costs			
(92 plus) A			
(81-91) B			
(69-80) C			
(55-68) D			
(39-54) E			
(21-38) F			
(1-20) G			
Not energy efficient - higher running costs			
England & Wales	EU Directive 2002/91/EC		

Environmental Impact (CO ₂) Rating		Current	Potential
Very environmentally friendly - lower CO ₂ emissions			
(92 plus) A			
(81-91) B			
(69-80) C			
(55-68) D			
(39-54) E			
(21-38) F			
(1-20) G			
Not environmentally friendly - higher CO ₂ emissions			
England & Wales	EU Directive 2002/91/EC		



Messrs Rounthwaite & Woodhead for themselves and their vendors and lessors whose agents they are give notice that these particulars are produced in good faith, set out as a general guide only and do not constitute any part of a contract. No person employed by Messrs Rounthwaite & Woodhead has any authority to make or give any representation or warranty whatsoever in relation to this property. The dimensions in the sales particulars are approximate only and the accuracy of any description cannot be guaranteed. Reference to machinery, services and electrical goods does not indicate that they are in good or working order. All reference to prices and rents etc. exclude VAT which may apply in some cases.

Covering Ryedale through offices in Malton, Pickering and Kirkbymoorside

www.rounthwaite-woodhead.com

Rounthwaite **R&W** Woodhead